

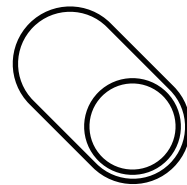

yeedi

Instruction Manual
Manuel d'instructions
Manual de instrucciones

K652G



EN	Instruction Manual.....	2
FR-CA	Manuel d'instructions	27
ES-LA	Manual de instrucciones.....	51

Important Safety Instructions

IMPORTANT SAFETY INSTRUCTIONS

READ ALL INSTRUCTIONS BEFORE USING THIS APPLIANCE.

For Household use only

When using an electrical appliance, basic precautions should always be followed, including the following:

WARNING: Read all safety warnings and instructions. Failure to follow the warnings and instructions may result in electric shock, fire or serious injury.

1. Do not allow to be used as a toy. Close attention is necessary when used by or near children.
2. Clear the area to be cleaned. Remove power cords and small objects from the floor that could entangle the Appliance. Tuck rug fringe under the rug base, and lift items such as curtains and tablecloths off the floor.
3. If there is a drop off in the cleaning area due to a step or stairs, you should operate

the Appliance to ensure that it can detect the step without falling over the edge. It may become necessary to place a physical barrier at the edge to keep the unit from falling. Make sure the physical barrier is not a trip hazard.



4. Only use as described in this manual. Only use attachments recommended or sold by the manufacturer.
5. Please make sure your power supply voltage matches the power voltage marked on the Docking Station.
6. Do not handle plug or appliance with wet hands.
7. Non-rechargeable batteries are prohibited.
8. Do not use without dust bin and/or filters in place.
9. Do not operate the vacuum in an area where there are lit candles or fragile objects on the floor to be cleaned.
10. Do not use and store in extremely hot or cold environments (below -5°C / 23°F or above 40°C / 104°F). Please charge the robot in temperature above 0°C / 32°F and below 40°C / 104°F .

11. Keep hair, loose clothing, fingers, and all parts of body away from any openings and moving parts.
12. Do not operate the Appliance in a room where an infant or child is sleeping.
13. For INDOOR use ONLY. Do not use the Appliance in outdoor, commercial or industrial environments. Do not use Appliance on wet surfaces or surfaces with standing water.
14. Do not allow the Appliance to pick up large objects like stones, large pieces of paper or any item that may clog the Appliance.
15. Do not use Appliance to pick up flammable or combustible materials such as gasoline, printer or copier toner, or use in areas where they may be present.
16. Do not use Appliance to pick up anything that is burning or smoking, such as cigarettes, matches, hot ashes, or anything that could cause a fire.
17. Do not put any object into openings. Do not use with any opening blocked; keep free of dust, lint, hair, and anything that may reduce air flow.
18. Take care not to damage the power cord. Do not pull on or carry the Appliance or Docking Station by the power cord, use the power cord as a handle, close a door on the power cord, or pull power cord around sharp edges or corners. Do not run Appliance over the power cord. Keep power cord away from hot surfaces. Do not unplug by pulling on cord. To unplug, grasp the plug, not the cord.
19. If the power cord is damaged, it must be replaced by the manufacturer or its service agent in order to avoid a hazard.
20. Do not use the Docking Station if it is damaged.
21. Do not use with a damaged power cord or plug. Do not use the Appliance or Docking Station if it is not working properly, has been dropped, damaged, left outdoors, or come in contact with water. It must be repaired by the manufacturer or its service agent in order to avoid a hazard.
22. Turn OFF the power switch before cleaning or maintaining the Appliance. Turn off all controls before unplugging.

23. The plug must be removed from the receptacle before cleaning or maintaining the Docking Station.
24. Remove the Appliance from the Docking Station, and turn OFF the power switch to the Appliance before removing the battery for disposal of the Appliance.
25. The battery must be removed and discarded according to local laws and regulations before disposal of the Appliance.
26. Please dispose of used batteries according to local laws and regulations.
27. Do not incinerate the Appliance even if it is severely damaged. The batteries can explode in a fire.
28. When not using the Docking Station for a long period of time, please unplug it.
29. The Appliance must be used in accordance with the directions in this Instruction Manual. REECO cannot be held liable or responsible for any damages or injuries caused by improper use.
30. Prevent unintentional starting. Ensure the switch is in the off position before connecting to battery pack, picking up or carrying the appliance. Carrying the appliance with your finger on the switch or energizing appliance that have the switch on invites accidents.
31. When battery pack is not in use, keep it away from other metal objects, like paper clips, coins, keys, nails, screws or other small metal objects, that can make a connection from one terminal to another. Shorting the battery terminals together may cause burns or a fire.
32. Under abusive conditions, liquid may be ejected from the battery; avoid contact. If contact accidentally occurs, flush with water. If liquid contacts eyes, additionally seek medical help. Liquid ejected from the battery may cause irritation or burns.
33. Do not use a battery pack or appliance that is damaged or modified. Damaged or modified batteries may exhibit unpredictable behavior resulting in fire, explosion or risk of injury.

34. Do not expose a battery pack or appliance to fire or excessive temperature. Exposure to fire or temperature above 130°C may cause explosion. The temperature of 130°C can be replaced by the temperature of 265°F.
35. Follow all charging instructions and do not charge the battery pack or appliance outside of the temperature range specified in the instructions. Charging improperly or at temperatures outside of the specified range may damage the battery and increase the risk of fire.
36. Have servicing performed by a qualified repair person using only identical replacement parts. This will ensure that the safety of the product is maintained.
37. Do not modify or attempt to repair the appliance or the battery pack (as applicable) except as indicated in the instructions for use and care.
38. Place the cords from other appliances out of the area to be cleaned.
39. Do not operate the vacuum in a room that has lit candles on furniture that the vacuum may accidentally hit or bump into.
40. Do not allow children to sit on the vacuum.
41. Recharge only with the charger specified by the manufacturer. A charger that is suitable for one type of battery pack may create a risk of fire when used with another battery pack.
42. Use appliances only with specifically designated battery packs. Use of any other battery packs may create a risk of injury and fire.
43. The robot contains batteries that are only replaceable by skilled persons. To replace the robot's battery, please contact Customer Service.
44. If the robot will not be used for a long time, fully charge the robot and power OFF for storage and unplug the Docking Station.

SAVE THESE INSTRUCTIONS

	Direct current
	Alternating current

Federal Communications Commission (FCC) Interference Statement

This equipment has been tested and found to comply with the limits for a Class B digital device, pursuant to Part 15 of the FCC Rules.

These limits are designed to provide reasonable protection against harmful interference in a residential installation. This equipment generate, uses and can radiate radio frequency energy and, if not installed and used in accordance with the instructions, may cause harmful interference to radio communications.

However, there is no guarantee that interference will not occur in a particular installation. If this equipment does cause harmful interference to radio or television reception, which can be determined by turning the equipment off and on, the user is encouraged to try to correct the interference by one of the following measures:

- Reorient or relocate the receiving antenna.
- Increase the separation between the equipment and receiver.
- Connect the equipment into an outlet on a circuit different from that to which the receiver is connected.
- Consult the dealer or an experienced radio/TV technician for help.

This device complies with Part 15 of the FCC Rules.

Operation is subject to the following two conditions:

(1) This device may not cause harmful interference, and (2) this device must accept any interference received, including interference that may cause undesired operation.

FCC Caution: Any changes or modifications not expressly approved by the party responsible for compliance could void the user's authority to operate this equipment.

RF exposure warning

This equipment complies with FCC radiation exposure limits set forth for an uncontrolled environment.

This equipment must be installed and operated in accordance with provided instructions and the antenna(s) used for this transmitter must be installed to provide a separation distance of at least 20 cm from all persons and must not be collocated or operating in conjunction with any other antenna or transmitter.

To disable Wi-Fi module on Robot, power the robot ON. Place the robot on the Docking Station making sure the Charging Contacts on Robot and the Docking Station Pins make a connection.

Press and hold the AUTO Mode Button on the robot for 20 seconds until Robot emits 3 beeps.

To enable Wi-Fi module on Robot, power the robot OFF and then power ON. The Wi-Fi module is turned on when Robot is restarted.

Contents

1. Package Contents	9
2. Operating and Programming.....	12
3. Maintenance	19
4. Troubleshooting.....	23
5. Product Specifications.....	26

1. Package Contents/1.1 Package Contents

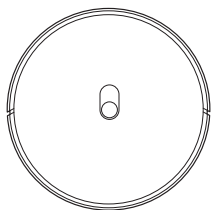

Robot

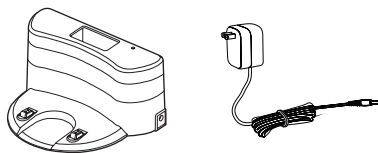

Docking Station+Power Adapter

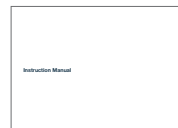

Instruction Manual

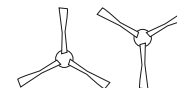

Side Brushes



Main Brush (Pre-installed)

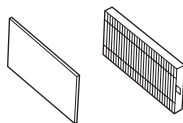

High Efficiency Filter &
Sponge Filter

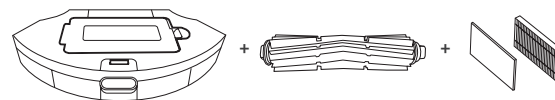

XL Dust Bin + Tangle-free Brush + Filter for XL Dust Bin

Note: Figures and illustrations are for reference only and may differ from actual product appearance. Product design and specifications are subject to changes without notice.

1. Package Contents/1.2 Product Diagram

Robot

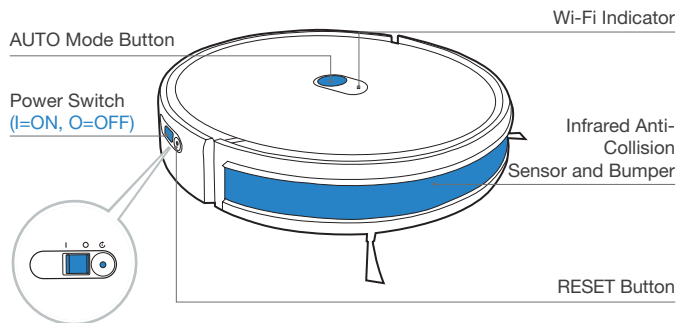

Bottom

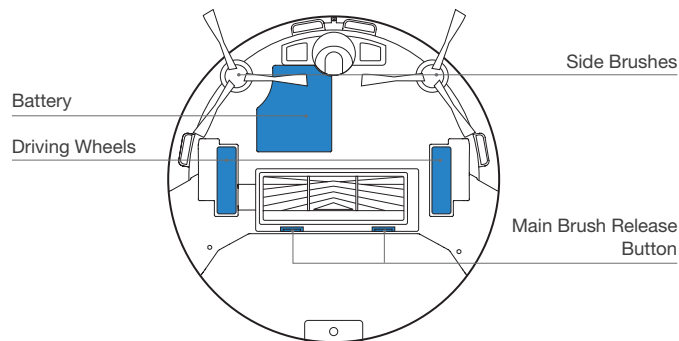
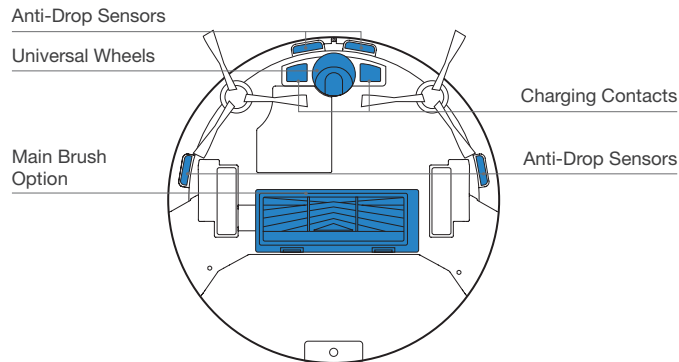

XL Dust Bin

Filter Cover Release Button

Dust Bin Release Button

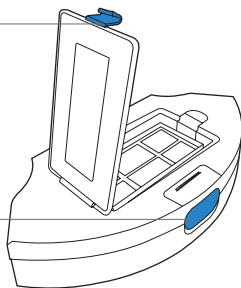

Sponge Filter

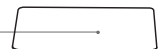

High Efficiency Filter



Filter Net

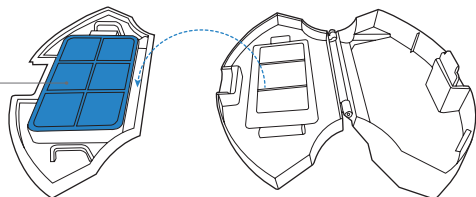

Docking Station

Infrared Signal Emitter

Charging Contacts

Power Adapter Port

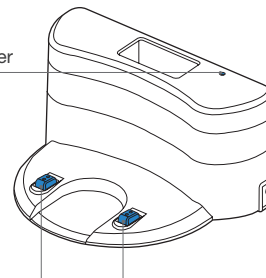

2. Operating and Programming/2.1 Notes Before Cleaning

Tidy up the area to be cleaned by putting furniture, such as chairs, in their proper place.

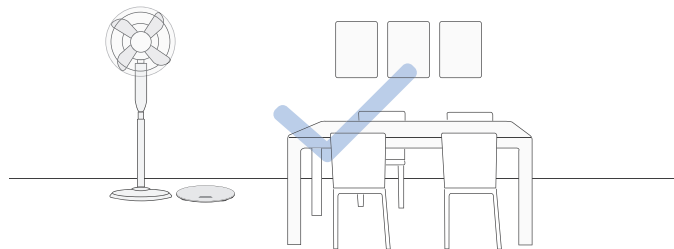

It may be necessary to place a physical barrier at the edge of a drop to stop the unit from falling over the edge.

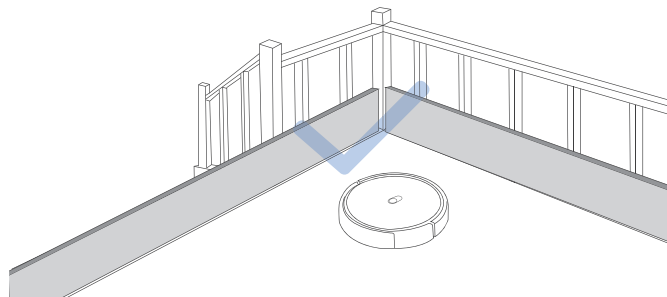

Put away objects including wires, cloths and slippers, etc. on the floor to improve the cleaning efficiency.



Before using the product on a rug with tasseled edges, please fold the rug edges under.



Please do not stand in narrow spaces, such as hallways, and make sure not to block Robot.

2. Operating and Programming/2.2 Quick Start

1 Remove Protective Materials

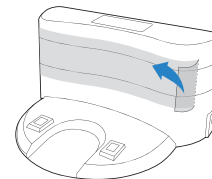
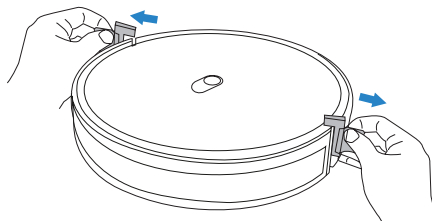
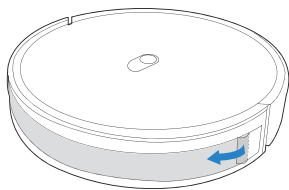

2 Install Side Brushes

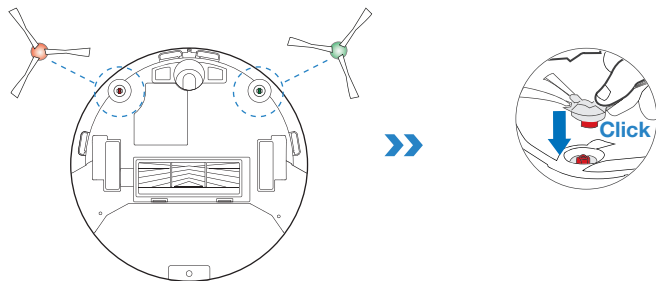

2. Operating and Programming/2.3 Charging Robot

1 Docking Station Placement

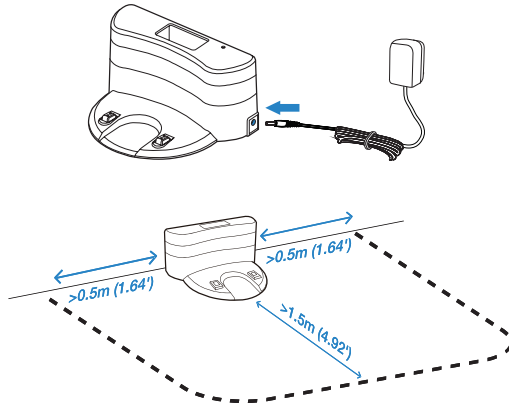

3 Charge Robot

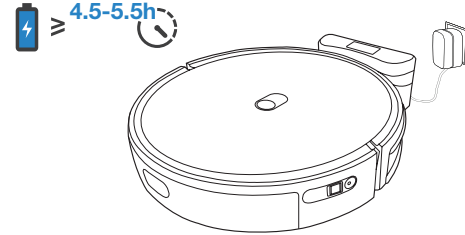

* It is suggested to avoid picking up or moving Robot during the cleaning for Robot to return to charge successfully.

2 Power ON

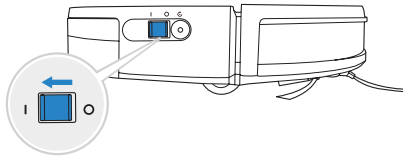

Note: I = ON, O = OFF

! Robot cannot be charged when being powered OFF.

2. Operating and Programming/ 2.4 Yeedi App

To enjoy all available features, it is recommended to control your Robot via the Yeedi app.

Before you start, make sure that:

- Your mobile phone is connected to a Wi-Fi network.
- The 2.4GHz band wireless signal is enabled on your router.
- The Wi-Fi indicator light on Robot is slowly flashing.

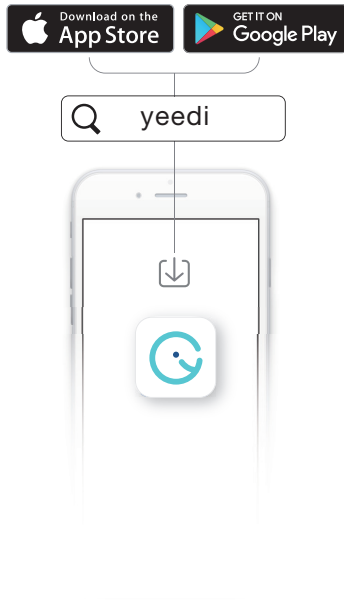

Wi-Fi Indicator Light

	Slowly flashing	Disconnected to Wi-Fi or waiting for Wi-Fi connection
	Rapidly flashing	Connecting to Wi-Fi
	Solid	Connected to Wi-Fi

Tips:

If you have any problems during the Wi-Fi setup process, refer to the Troubleshooting > Wi-Fi Connection section in this manual.

2. Operating and Programming/ 2.5 Operating Robot

During the first cleaning, please supervise Robot and assist it should there be a problem.

1 Start

Robot will clean in **Random Cleaning Pattern** designed for carpet cleaning by default.

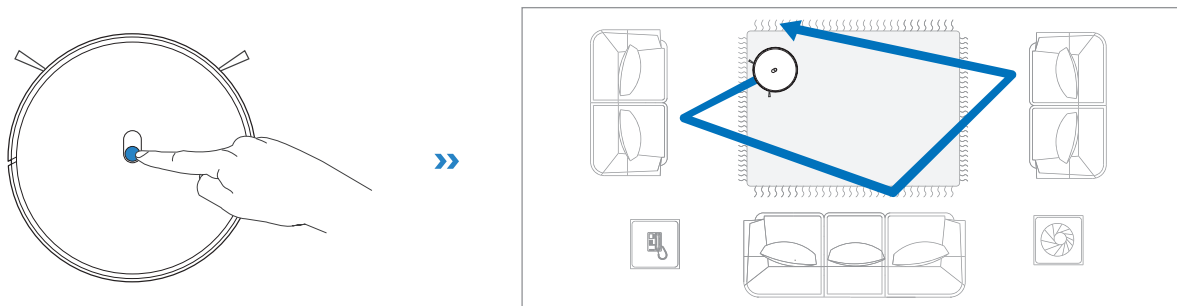

2 Start/Pause

The robot's Control Panel stops glowing after the robot is paused for a few minutes. Press the AUTO Mode Button on Robot to wake up the robot.

Pause

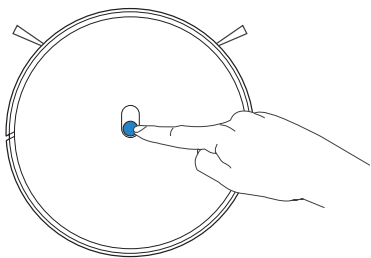

Wake Up

Start

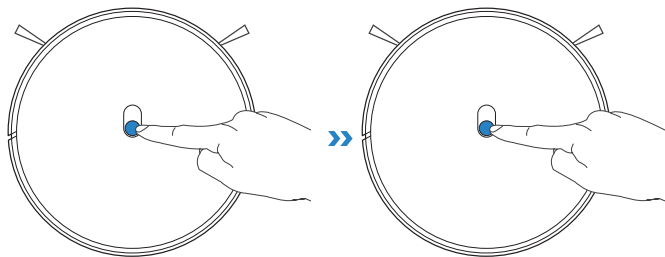

3 Power OFF

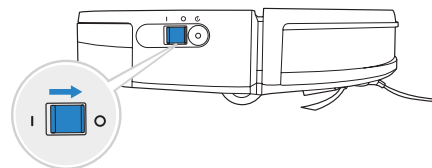

- * If Robot will not be used for a while, fully charge Robot and power OFF before storage. Charge Robot every 1.5 month to prevent battery drain.
- * When Robot is not cleaning, it is recommended to keep Robot powered ON and charging.

2. Operating and Programming/2.6 Tangle-free Brush

Tangle-free Brush is specifically designed to pick up hair without tangling. It is suggested to increase the vacuum power in Yeedi App when using Tangle-free Brush.

Install Tangle-free Brush

1 Release the Brush Cover

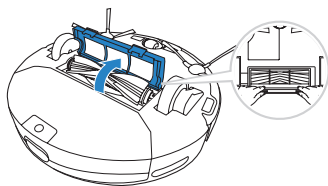

3 Install Tangle-free Brush

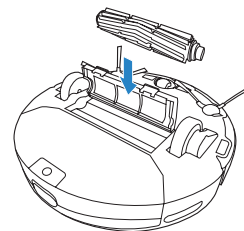

2 Uninstall the Main Brush

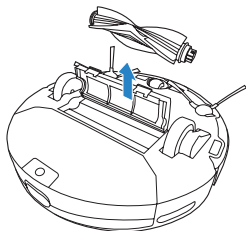

3. Maintenance/3.1 Regular Maintenance

To keep Robot running at peak performance, perform maintenance tasks and replace parts with the following frequencies:

Robot Part	Maintenance Frequency	Replacement Frequency
Side Brush	Once every 2 weeks	Every 3-6 months
Main Brush Tangle-free Brush	Once per week	Every 6-12 months
Sponge Filter/ High Efficiency Filter	Once per week	Every 3-6 months
Universal Wheel Anti-Drop Sensors Bumper Charging Contacts Docking Station Pins	Once per week	/

Before performing cleaning and maintenance tasks on Robot, turn the robot OFF and unplug the Docking Station.

A multi-function Cleaning Tool is provided for easy maintenance. Handle with care, this cleaning tool has sharp edges.

Note: REECO manufactures various replacement parts and fittings. Please contact Customer Service for more information on replacement parts.

3. Maintenance/3.2 XL Dust Bin

1

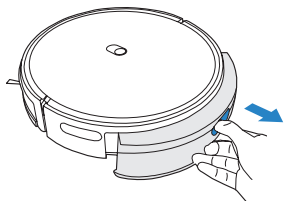

2

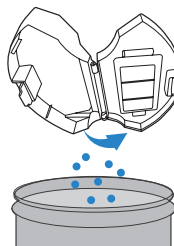

3

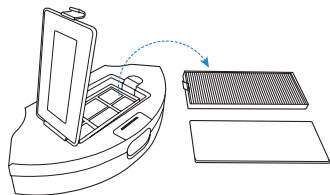

4

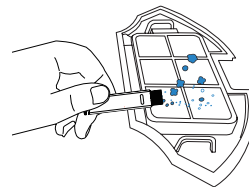

5

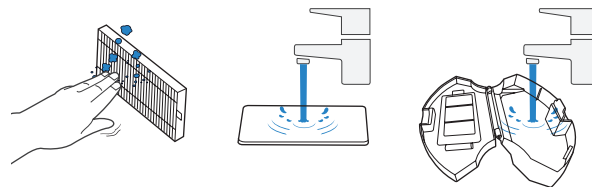

6

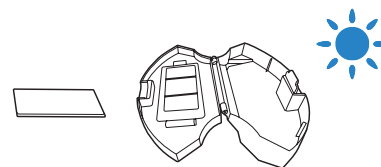

3. Maintenance/3.3 Main Brush & Side Brushes

Main Brush

1

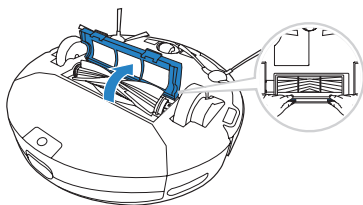

2

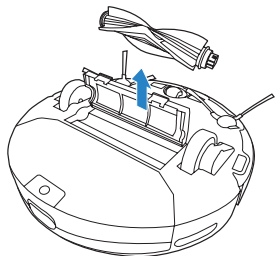

3

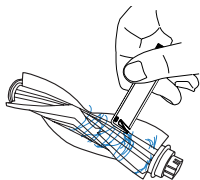

Side Brushes

1

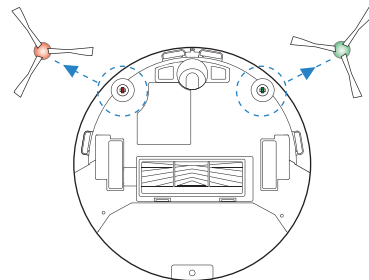

2

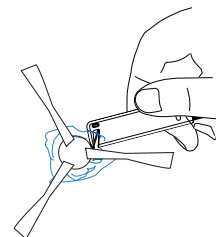

3. Maintenance/3.4 Other Components

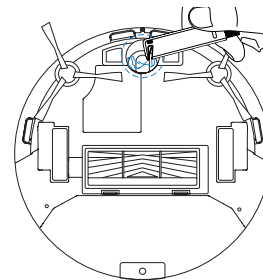
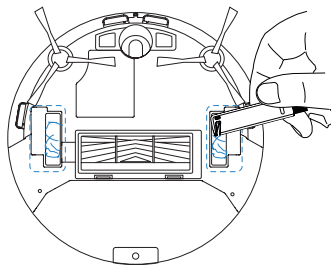
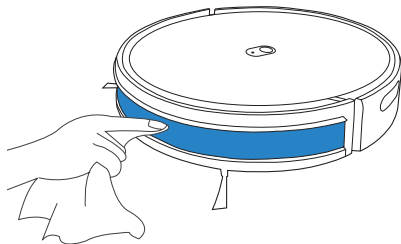
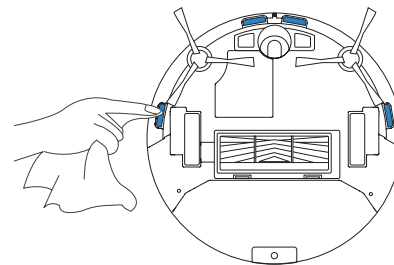
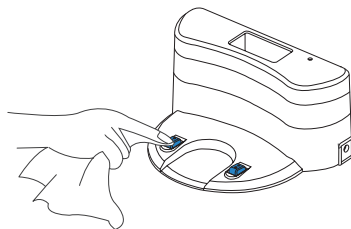
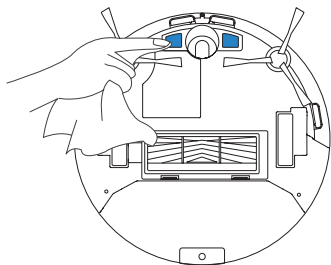

4. Troubleshooting/4.1 Troubleshooting

No.	Scenario	Possible Cause	Solution
1	Robot is not able to connect to the home Wi-Fi network.	Incorrect home Wi-Fi username or password entered.	Enter the correct home Wi-Fi username and password.
		Robot is not within range of your home Wi-Fi signal.	Make sure Robot is within range of your home Wi-Fi signal.
		Network setup started before Robot was ready.	Turn ON Power Switch. Press the RESET Button. Robot is ready for network setup when its Wi-Fi Indicator light flashes slowly.
		Robot does not support 5 GHz Wi-Fi.	Make sure the robot has been connected with 2.4 GHz Wi-Fi network.
2	Robot is not charging.	Robot is not switched ON.	Switch ON Robot.
		Robot has not connected to the Docking Station.	Be sure that the robot's Charging Contacts have connected to the Docking Station Pins.
		The Docking Station is not connected to the power supply.	Make sure the Docking Station is connected to the power supply.
		The battery is completely discharged.	Please contact Customer Care for help.

No.	Scenario	Possible Cause	Solution
3	Robot cannot return to the Docking Station.	The Docking Station is not correctly placed.	Refer to Section 3.2 correctly place the Docking Station.
		The Docking Station is not correctly connected.	Make sure the Docking Station is correctly connected.
		The Docking Station is manually moved during the cleaning.	It is suggested not to move the Docking Station during the cleaning.
		Robot did not start cleaning from the Docking Station.	Make sure Robot starts cleaning from the Docking Station.
4	Robot misses cleaning spots to be cleaned, or repeats cleaning the area cleaned.	The cleaning cycle is interfered by small objects or barriers on the floor.	Remove power cords and small objects from the floor to ensure cleaning efficiency. Robot will automatically clean the area missed, please avoid moving Robot manually or block the path during the cleaning cycle.
		Robot is working on slippery polished floors.	Make sure the floor wax is dried before Robot starts cleaning.
		Robot is unable to reach certain areas blocked by furniture or barriers.	Tidy up the area to be cleaned by putting furniture and small objects in their proper place.
5	Robot gets stuck while working and stops.	Robot gets stuck while working and stops.	Robot will try various ways to free itself. If it is unsuccessful, manually remove the obstacles and restart.
		Robot might be stuck under furniture with an entrance of similar height.	Please set a physical barrier.
6	Robot is making too much noise when cleaning.	Robot is tangled or blocked with debris.	Clean Robot as described in section Maintenance and restart. If the trouble persists, please contact Customer Care.

4. Troubleshooting/4.2 Wi-Fi Connection

Before Wi-Fi setup, make sure Robot, mobile phone, and Wi-Fi network meet the following requirements.

Robot and Mobile Phone Requirements

- Robot is fully charged and the power switch of Robot is turned on.
- Wi-Fi status light slowly flashes.
- Turn off mobile phone's cellular data (you can turn it back on after setup).

Wi-Fi Network Requirements

- You are using a 2.4GHz or 2.4/5 GHz mixed network.
- Your router supports 802.11b/g/n and IPv4 protocol.
- Do not use a VPN (Virtual Private Network) or Proxy Server.
- Do not use a hidden network.
- WPA and WPA2 using TKIP, PSK, AES/CCMP encryption.
- WEP EAP (Enterprise Authentication Protocol) is not supported.
- Use Wi-Fi channels 1-11 in North America and channels 1-13 outside North America (refer to local regulatory agency).
- If you are using a network extender/repeater, the network name (SSID) and password are the same as your primary network.

5. Product Specifications

Model	K652G		
Rated Input	19V \equiv 0.6A 11.4W		
Docking Station Model	DN622.13		
Rated Output Voltage	19V \equiv	Rated Output Current	0.6A
Power Adapter Model	DK18-190060H-U		

Note: Technical and design specifications may be changed for continuous product improvement.