

2

Install your Ring Doorbell Pro



ring





If you need extra help...

Ring Community Support is available 7 days a week, and our online help center is accessible 24/7.

Visit our online help center at: ring.com/help

Contact Ring Community Support directly at:

US 1.800.656.1918

UK 01727 263045

Worldwide +1 310.929.7085
help@ring.com

There's even a video on this whole process...

There's a video in the Ring app on the installation process outlined in this manual. We recommend watching that first, and referring to this manual if you need extra help.

Select the + sign to Add a New Device (or tap Set Up a Device), then select Video Doorbell Pro to access this video:



Step 1

Say “Hello” to your Ring Video Doorbell Pro

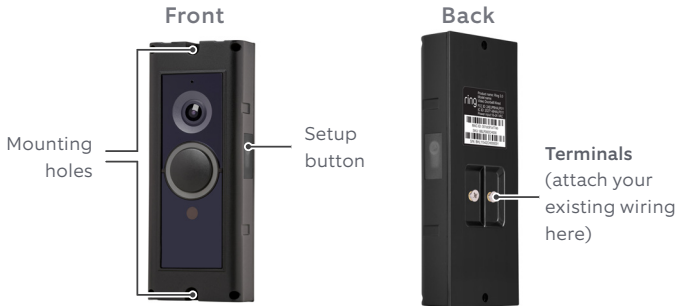

4 Faceplates

Pick the one that best matches your home...or your mood.
Change it any time.

Step 2

Check out all the cool stuff in the box



1 Screwdriver - Use the Phillips end for the mounting screws and star-shaped end for the security screw.



3 Anchors - For installing on concrete, stucco, or brick.

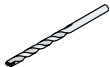

1 Drill Bit - To drill holes for the (optional) anchors.



3 Mounting Screws - Use two to mount your Ring.



2 Security Screws - Use one to secure the faceplate.



2 Extra Wires - To attach your existing wires to your Ring.



2 Wire connectors - To connect the extra wires (above) to your existing wires.



Step 3

Remove your existing doorbell

Remove your existing doorbell from the wall and disconnect the wires.

Step 4

Install anchors (on stucco, brick, or concrete)

On **stucco, brick, or concrete**, use the provided bit to drill two holes in your wall, and install the anchors.

If you're installing on **wood** or **siding**, put the anchors in that drawer of stuff you never use and skip this step.

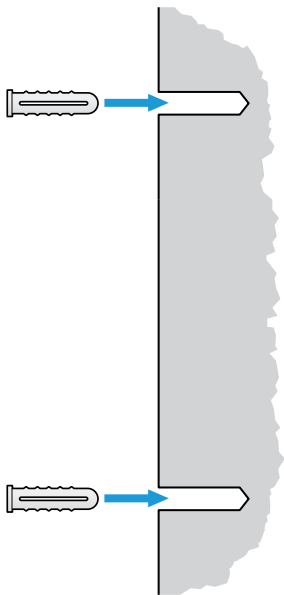

Step 5

Remove the Faceplate

Remove the faceplate on your Ring Doorbell Pro to access the mounting holes.

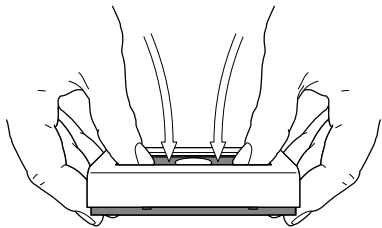

After your Ring Doorbell is installed, remove the faceplate like this:

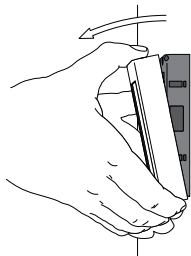

Step 6

Connect Ring Doorbell to your existing wires

It doesn't matter which wire connects to which screw.

Then feed the wiring into your wall, and screw in your Ring.



Ring Doorbell Pro requires
voltage between **16 and 24 VAC**

Step 7

Restore power at the breaker

The hard part is over—congrats! After restoring power at the breaker, open the Ring app, select the option to **Set Up a New Device**, and follow the in-app instructions.

