

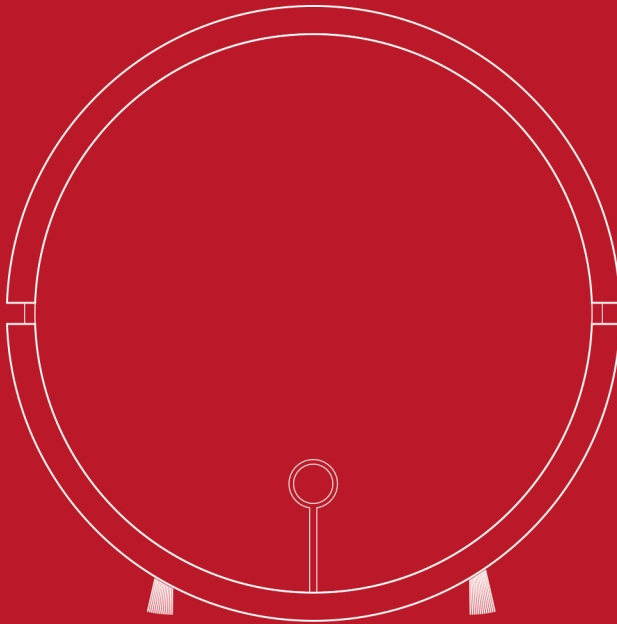

COSTWAY

WHERE THERE IS COSTWAY THERE IS HOME



USER'S MANUAL

Intelligent Vacuum Robot

HW60322BK HW60322WH

HW60323BK HW60323WH

Content

1. Important Safety Instructions	3
2. Package Contents and Technical Specifications	4
2.1 Product Diagram	4
2.2 Specifications	6
3. Operating and Programming	7
3.1 Notes Before Cleaning	7
3.2 Quick Start	8
3.3 Cleaning Mode Selection	9
3.4 Intelligent Scheduling	10
4. Maintenance	14
4.1 Water Tank Components.....	14
4.2 Dust Bin and Filters	15
4.3 Main Brush	16
4.4 Side Brushes	17
4.5 Other Components	17
5. Alarm Indicator and Sounds	18
6. Troubleshooting	19

1. Important Safety Instructions

**When using an electrical appliance, basic precautions should always be followed, including the following:
READ ALL INSTRUCTIONS BEFORE USING THIS APPLIANCE. SAVE THESE INSTRUCTIONS**

1. This Appliance is not intended to be used by children under 8 or anyone lacking knowledge on proper use. Supervision may be necessary. Do not allow children to sit on or play with the Appliance.
2. Clear the area to be cleaned. Remove power cords and small objects from the floor that could entangle the Appliance. Tuck rug fringe under the rug base, and lift items such as curtains and tablecloths off the floor.
3. If there is a drop off in the cleaning area due to a step or stairs, you should operate the Appliance to ensure that it can detect the step without falling over the edge. It may become necessary to place a physical barrier at the edge to keep the unit from falling. Make sure the physical barrier is not a trip hazard.
4. Only use as described in this manual. Only use attachments recommended or sold by the manufacturer.
5. Please make sure your power supply voltage matches the power voltage marked on the Charging Dock.
6. For INDOOR household use ONLY. Do not use the Appliance in outdoor, commercial or industrial environments.
7. Use only the original rechargeable battery and Charging Dock provided with the Appliance from the manufacturer. Non-rechargeable batteries are prohibited. For battery information, please refer to Specifications section.
8. Do not use without dust bin and/or filters in place.
9. Do not operate the Appliance in an area where there are lit candles or fragile objects.
10. Do not use in extremely hot or cold environments (below -5°C/23°F or above 40°C/104°F).
11. Keep hair, loose clothing, fingers, and all parts of body away from any openings and moving parts.
12. Do not operate the Appliance in a room where an infant or child is sleeping.
13. Do not use Appliance on wet surfaces or surfaces with standing water.
14. Do not allow the Appliance to pick up large objects like stones, large pieces of paper or any item that may clog the Appliance.
15. Do not use Appliance to pick up flammable or combustible materials such as gasoline, printer or copier toner, or use in areas where they may be present.
16. Do not use Appliance to pick up anything that is burning or smoking, such as cigarettes, matches, hot ashes, or anything that could cause a fire.
17. Do not put objects into the suction intake. Do not use if the suction intake is blocked. Keep the intake clear of dust, lint, hair, or anything that may reduce air flow.
18. Take care not to damage the power cord. Do not pull on or carry the Appliance or Charging Dock by the power cord, use the power cord as a handle, close a door on the power cord, or pull power cord around sharp edges or corners. Do not run Appliance over the power cord. Keep power cord away from hot surfaces.
19. If the power cord is damaged, it must be replaced by the manufacturer or its service agent in order to avoid a hazard.
20. Do not use the Charging Dock if it is damaged.
21. Do not use with a damaged power cord or receptacle. Do not use the Appliance or Charging Dock if it is not working properly, has been dropped, damaged, left outdoors, or come in contact with water. It must be repaired by the manufacturer or its service agent in order to avoid a hazard.
22. Turn OFF the power switch before cleaning or maintaining the Appliance.
23. The plug must be removed from the receptacle before cleaning or maintaining the Charging Dock.
24. Remove the Appliance from the Charging Dock, and turn OFF the power switch to the Appliance before removing the battery for disposal of the Appliance.
25. The battery must be removed and discarded according to local laws and regulations before disposal of the Appliance.
26. Please dispose of used batteries according to local laws and regulations.
27. Do not incinerate the Appliance even if it is severely damaged. The batteries can explode in a fire.
28. When not using the Charging Dock for a long period of time, please unplug it.
29. The Appliance must be used in accordance with the directions in this Instruction Manual. The Robot cannot be held liable or responsible for any damages or injuries caused by improper use.

2. Package Contents and Technical Specifications

2.1 Product Diagram

Robot

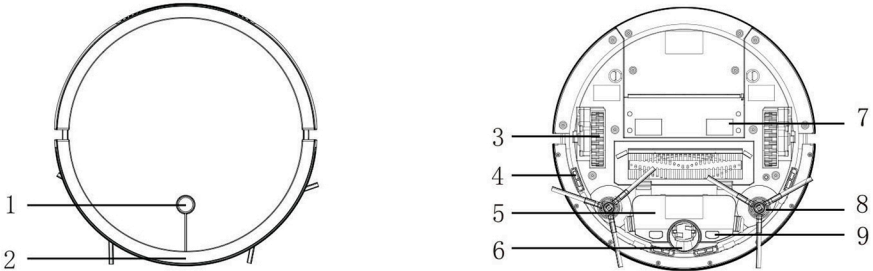

- | | | |
|---------------------------|----------------------|------------------------|
| 1. AUTO Mode Button | 4. Anti-Drop Sensors | 7. Dust Bin+Water Tank |
| 2. Anti-Collision Sensors | 5. Battery Pack | 8. Side Brushes |
| 3. Driving Wheels | 6. Universal Wheel | 9. Charging Contacts |

Control Panel

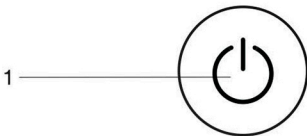

- | |
|---|
| 1.  AUTO Mode Button |
|---|

Charging Dock

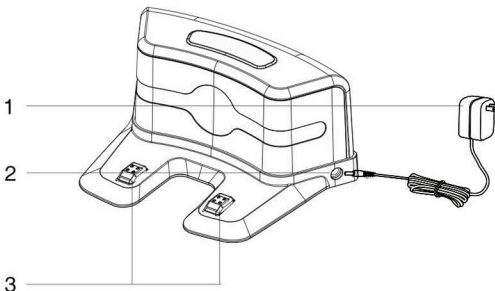

- | |
|-----------------------|
| 1. Power Adapter |
| 2. Power socket |
| 3. Charging Dock Pins |

2. Package Contents and Technical Specifications

Remote Control

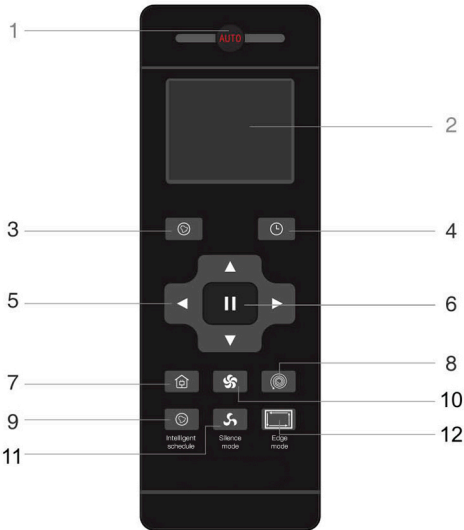

1. AUTO
2. Display Screen
3. Scheduling Button
4. Set Time
5. Direction Control Buttons
6. PAUSE Button
7. Return to Charger Mode Button
8. Spot Cleaning Mode Button
9. Intelligent Scheduling Button
10. Intensive Cleaning mode
Increase suction power,
Design for deeply cleaning
11. Silence mode button
12. Edge Cleaning Mode Button

Dust Bin

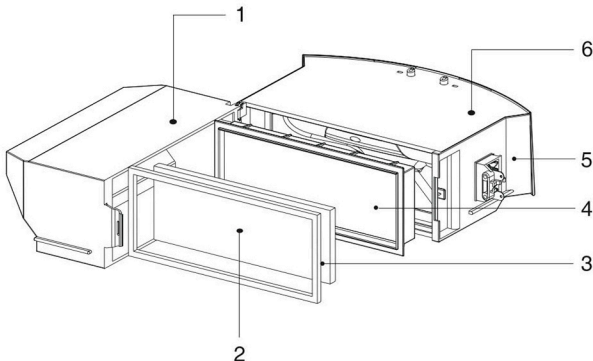

1. Dust Bin
2. Sponge Filter
3. Seal ring
4. High Efficiency Filter HEPA
5. Dust Bin back
6. Dust Bin Cover

2. Package Contents and Technical Specifications

Bumper Strip

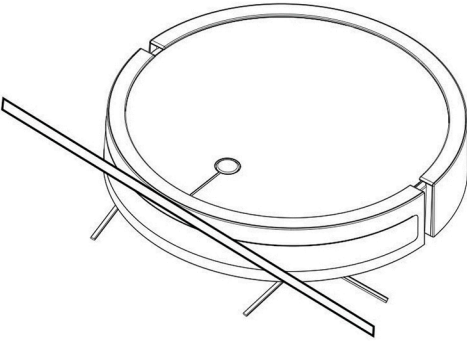

Optional component, stick start from either side of the bumper part

2.2 Specifications

Model	YBS1601/YBS1603		
Working voltage(V)	14.4===	Rated power(W)	30
Charging Dock			
Rated input voltage(V)	20===	Rated output current(A)	1
Remote Control			
Rated output voltage(V)	3 ===		
Battery	AAA battery x 2		

*Technical and design specifications may be changed in the course of continuous product improvement.

3. Operating and Programming

3.1 Notes before Cleaning

Before operating, take a few moments to survey the area to be cleaned and remove any obstacles.

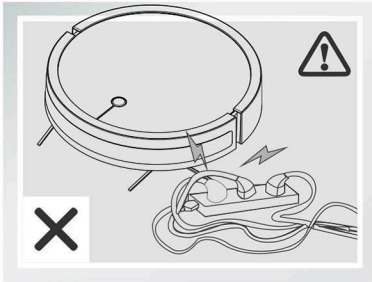

Remove power cords and small objects from the floor that could entangle the product

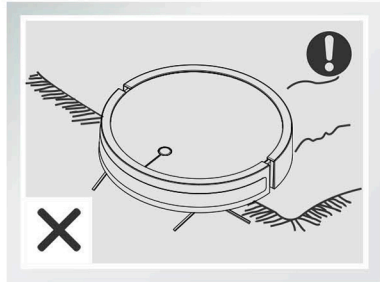

This product cleans bare floors and shortpile carpet. It is not designed to clean longpile or shag carpet.

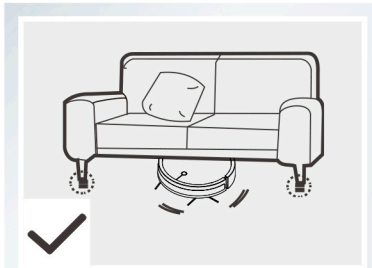

The furniture with bottom space less than 8cm may seize the product. If cleaning is needed, please raise the furniture.

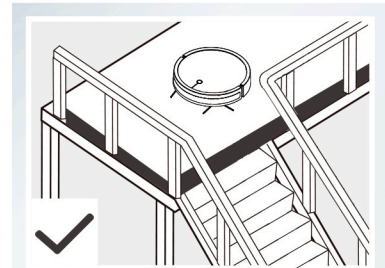

Please add fence to the edge of the duplex floor to ensure the safety of the product.



Please well arrange the furniture incase any stuck

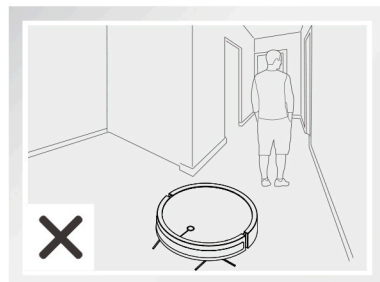

Please keep the corridor and other narrow area unobstructed

3. Operating and Programming

3.2 Quick Start

1 Prepare the charging dock

- Connect the Charging Dock with the power adapter
- Place the Charging Dock on a level floor surface against the wall with the base perpendicular to the ground. Keep the immediate area 1.5m (5') in front of the charger and 0.5m (1.6') on both sides of the charger clear of objects and reflective object surfaces.
- Plug the Charging Dock in.

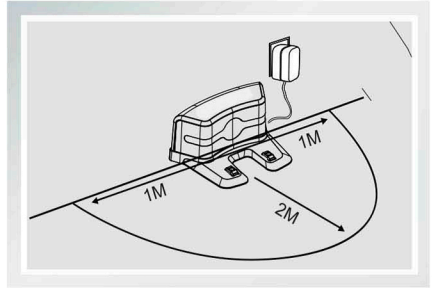
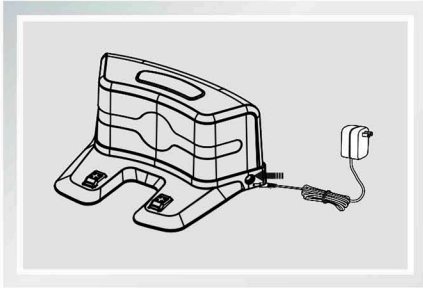

2 Charge

- Place ROBOT on the Charging Dock making sure the Charging Contacts on ROBOT and the Charging Dock Pins make a connection.

*AUTO Mode Button blinks in purple light when charging
AUTO Mode Button keep glowing in blue light when it is fully charged
For better experience, please charge for 12hours before first use.

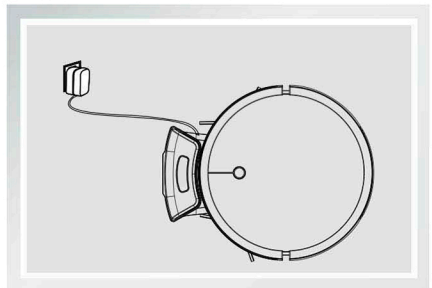

3. Operating and Programming

3 start

- Press the AUTO Mode Button on ROBOT or on the Remote Controller. ROBOT starts to work immediately in AUTO Cleaning Mode.

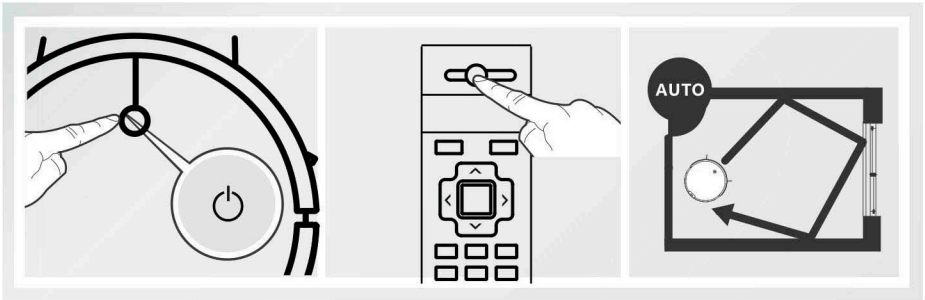

- * Before start, make sure the AUTO button is blinking blue light, which means it is activated, if not please long press AUTO button to active machine.
- * To choose another Cleaning Mode, please refer to section Cleaning Mode Selection for details.
- * ROBOT would have short stop while performing cleaning for area calculation, please wait for it done. Stop times various in different areas.

4 Pause

- Pause ROBOT by pressing the AUTO Mode Button on ROBOT or the START/PAUSE Button on the Remote Control.

* ROBOT will be fresh start again if press AUTO button again.

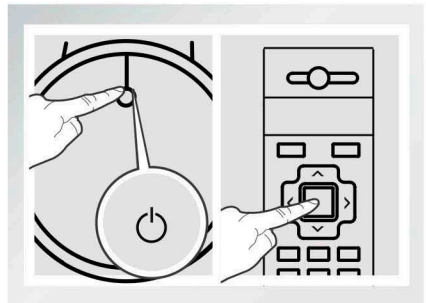

3.3 Cleaning Mode Selection

ROBOT has several Cleaning Modes to choose from to effectively clean different floors. Cleaning Modes are selected with the Remote Control.

- * Everytime switch back to AUTO mode, the machine will be fresh start to clean all areas.
- * Before start, make sure the AUTO button is blinking blue light, which means it is activated, if not please long press AUTO button to active machine.

3. Operating and Programming

1 AUTO MODE

- This is the most commonly used mode. In AUTO Cleaning Mode, ROBOT will clean automatically
INTENSIVE CLEAN: For most dirty floor
Silence mode: Save the power for daily use

- * ROBOT will reset its cleaning plan if change the clean mode or direction, for better result please let it done its work alone.
- * ROBOT would have short stop while performing cleaning for area calculation, please wait for it done. Stop times various in different areas.

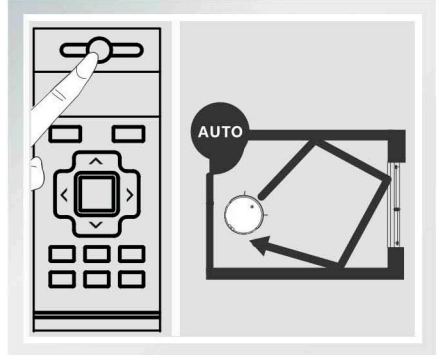

2 Spot Cleaning Mode

- This mode is applicable for an area of highly concentrated dirt or dust. In Spot Cleaning Mode, ROBOT focuses on a specific area to clean. ROBOT cleans the area in a spiral pattern and stops when it completes Spot Cleaning.

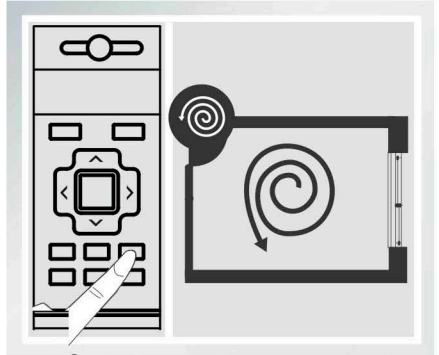

3 Edge Cleaning Mode

- This mode is good for cleaning the edges and corners of a room. In Edge Cleaning Mode, ROBOT cleans along a border (e.g. wall) and returns to the Charging Dock when it completes Edge Cleaning.

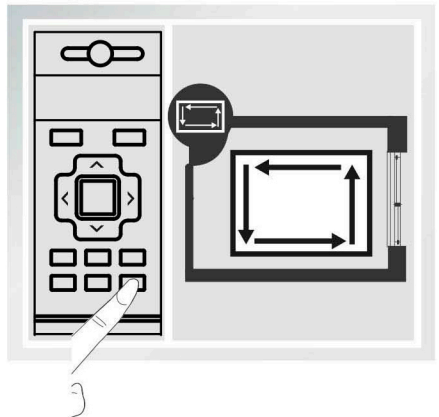

3. Operating and Programming

4 Return to Charger Mode

- When battery power gets low, ROBOT automatically switches to Return to Charger Mode and returns to the Charging Dock to recharge itself.

* ROBOT can also be sent back to the Charging Dock at any time by pressing the Return to Charger Button on the Remote Controller.

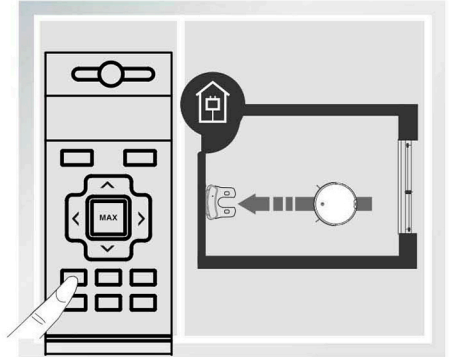

3.4 Scheduling

1 Set Scheduling

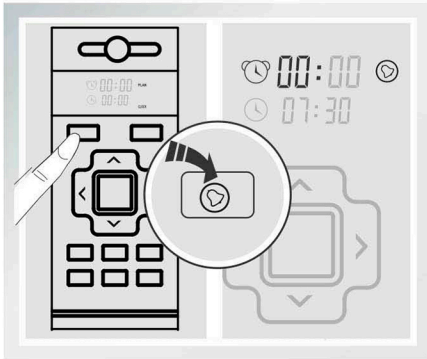

Press , the hours start blinking, then set the needed hour

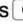
When done, press  to save the schedule, ROBOT will clean on the set time everyday

* Be sure press  to save, otherwise the schedule won't work

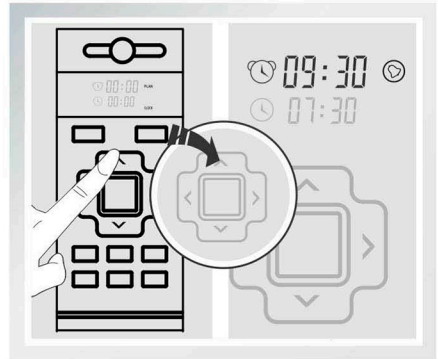

Change time by press direction buttons

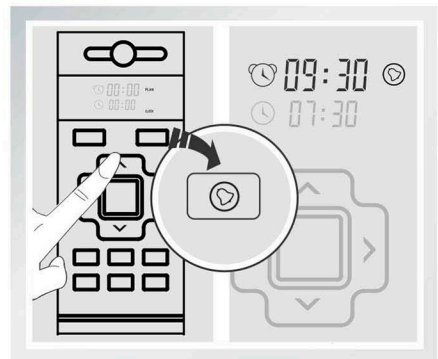

3. Operating and Programming

2 Set Intelligent Scheduling

Press , ROBOT will perform cleaning after 24 hours, be sure to set up the correct time on the controller first.

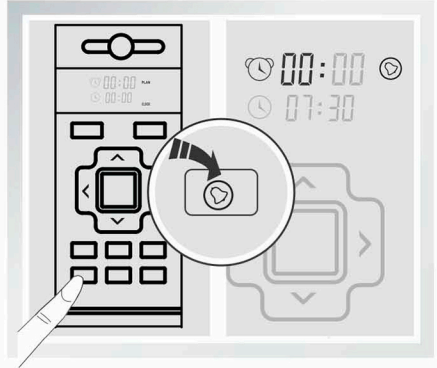

3 Cancel Scheduling

Press  Schedule or intelligent schedule button for 3 seconds

- * Each setting done with a sound alarm from ROBOT, if not the setting won't work
- * Be sure to reset the clock and schedule after change the controller battery.

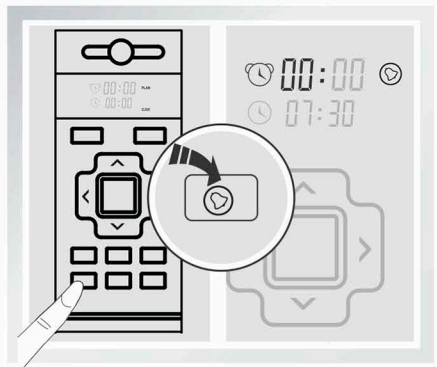
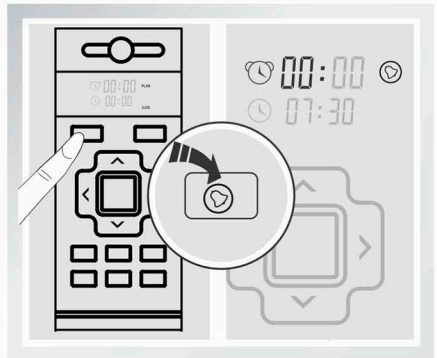

3. Operating and Programming

1 Clock setting

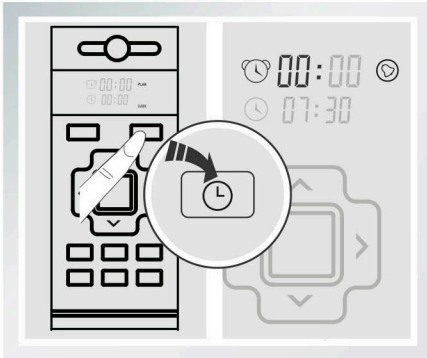

Press , the hour on the screen start blinking

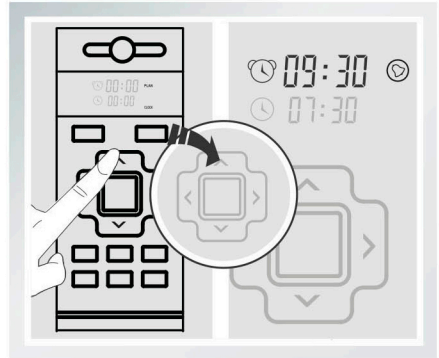

Change the time by press direction button

Press  when finish clock setting

*Setting won't work without press  when setting done

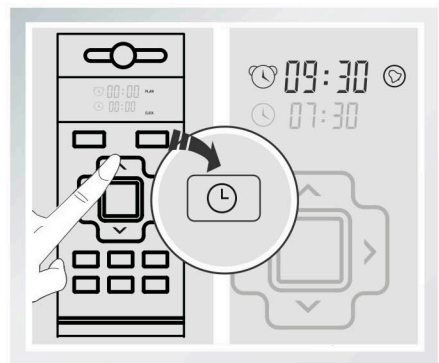

4. Maintenance

* Before performing cleaning and maintenance, power OFF ROBOT and unplug the Charging Dock.

4.1 Water tank components

For better Cleaning result, Please clean the water tank and mop after mopping.

1. Unload the water tank: after mopping, unload the water tank from the machine, take off the mop, and wash.

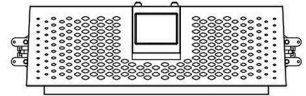

2. Open the Water Inlet lid on the Water tank and slowly pour the water in. Close the Water Inlet lid.

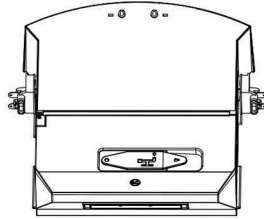

3. Wash the Cleaning Cloth by hand, and lay flat to dry.

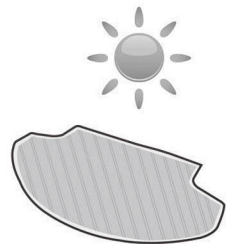

* Before performing cleaning and maintenance, power OFF ROBOT and unplug the Charging Dock.

4.2 Dust Bin and Filters

Cleaning the Dust Bin and Filters

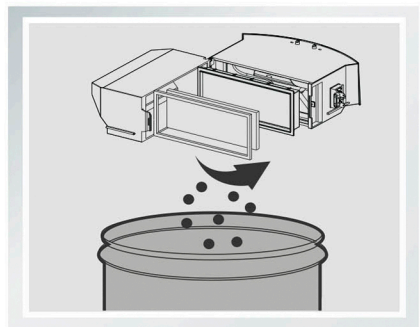
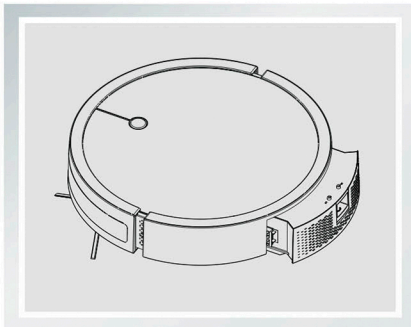

Remove the filters. Pat the High Efficiency Filter and Sponge Filter clean. Do not rinse the High Efficiency Filter under water.

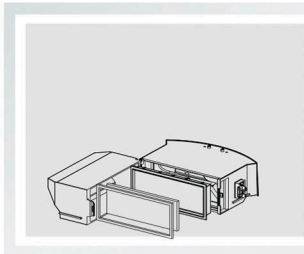

Rinse Filter Net under running water.

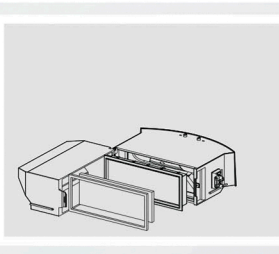

Dry the Dust Bin and filters completely before reinstalling.

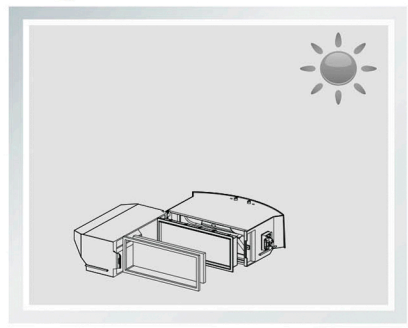
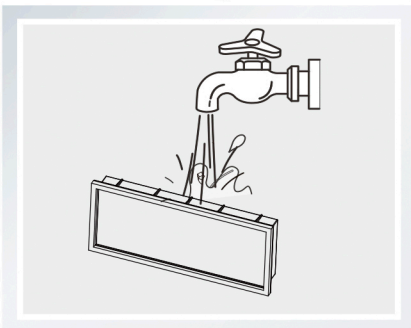
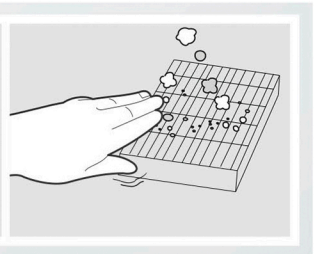

4. Maintenance

* Before performing cleaning and maintenance, power OFF ROBOT and unplug the Charging Dock.

4.3 Main brush

Unload the main brush: take off the cover and unload the main brush. please clean the main brush after used.

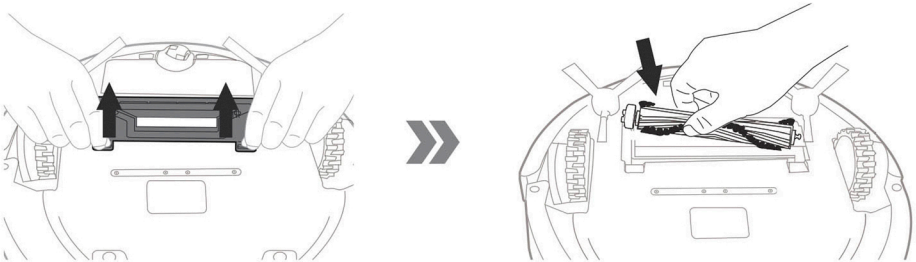

Install main brush: put on the main brush along with the slots on the both sides, put on the main brush cover.

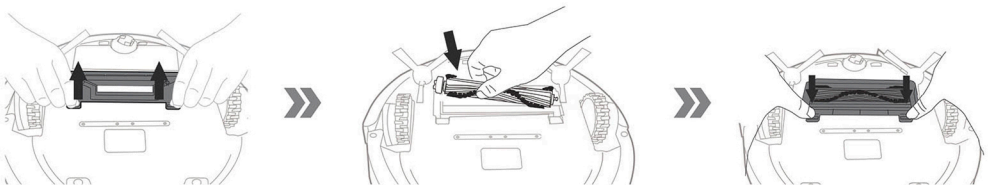

4. Maintenance

4.4 Side Brushes

Remove the Side Brushes and wipe the Side Brushes and their slots with a clean cloth.

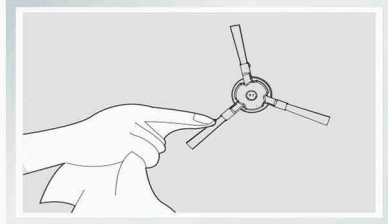

4.5 Other Components

Use the Multi-Function Cleaning Tool to cut off and remove any hair tangled around the Universal Wheel.

Wipe the Anti-Drop Sensors with the brush or felt side of the Multi-Function Cleaning Tool to maintain their effectiveness.

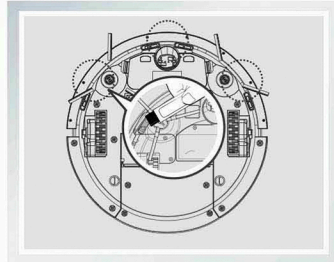
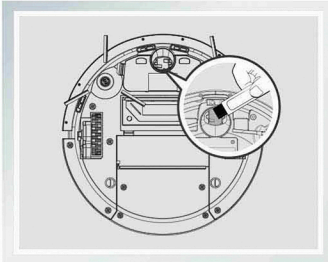

Wipe the robot's Charging Contacts and Charging Docks Pins with the brush of the Multi-Function Cleaning Tool or with a dry cloth to maintain their effectiveness.

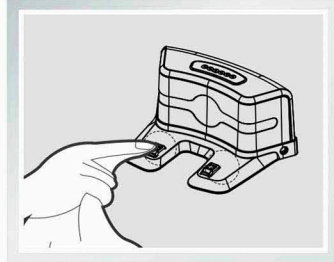
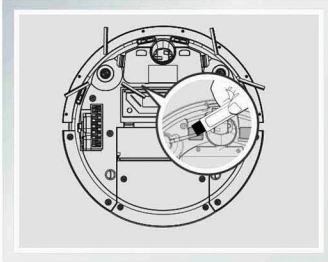

- * Remove the robot's battery if it will not be used for a long time. In case of battery leakage, please remove the battery and wipe the battery slot clean while wearing protective gloves.
- * If battery is fully discharged or not used for a long time, its capacity may decrease and need to be reactivated.
- * To reactivate the battery: Place the robot on the Charging Dock by hand, remove after charging for 3 minutes; repeat 3 times, then charge normally for 3-5 hours.
- * ROBOT uses a long life battery, and does not require frequent replacement. To replace the battery, contact Customer Service or follow the below instructions:
 - a. Unscrew the Battery Cover Screws, remove Battery Cover.
 - b. Remove the battery and disconnect the fasteners.
 - c. Connect the corresponding positive and negative fasteners on the new battery. Insert the new battery, reassemble the Battery Cover and screw in the Battery Cover Screws.

5. Alarm Indicator and Sounds

5.1 Alarm Indicator

Machine state	Display
Charging	Purple light breathing
Charging done	Blue light glowing
Selecting mode	Blue light blinking
Malfunction	Red light blinking
Low battery	Red light glowing
Clean mode	Blue light glowing

5.2 Sounds

If ROBOT detects a problem and needs your assistance, it emits alarm beeps and the Alarm Indicator flashes RED.

(• Means the beeping times)

No	Beeps	Problem	Solution
01	•	Machine Stucked	Move it to empty area, press start buttom
02	••	Dust Bin Malfunction	Remove the Dust Bin and re-install it properly. If the robot still emits the alarm, please contact Customer Service.
03	•••	Driving wheel or side brush or brush roll malfunction	If they do not click, please contact Customer Service.
04	••••	Anti-Drop Sensor Malfunction	Check Anti-Drop Sensors for dust and clean

Tips

Please try to reboot your machine if the above solution can not work
If there is still a problem, please contact customer service

6. Troubleshooting

Please use this chart to troubleshoot common problems using ROBOT

No.	Malfunction	Possible Causes	Solutions
1	ROBOT will not charge.	CONOCO has not made a connection with the Charging Dock.	Be sure that the robot's Charging Contacts have made a connection with the Charging Dock Pins. You may move the robot manually to make the connection if necessary.
		The Charging Dock is unplugged while ROBOT is powered ON, which causes battery consumption	Plug in the Charging Dock and ensure ROBOT is powered ON. Keep ROBOT on the Charging Dock to make sure it has full battery to work at any time.
		The battery is completely discharged.	Reactivate the battery. Place ROBOT on the Charging Dock by hand, remove after charging for 3 minutes, repeat 3 times; then charge normally.
2	ROBOT gets into trouble while working and stops.	ROBOT is tangled with something on the floor (electrical cords, drooping curtains, area rug fringe etc.).	ROBOT will try various ways to get itself out of trouble. If it is unsuccessful, manually remove the obstacles and restart.
3	ROBOT returns to the Charging Dock before it finishes cleaning.	When battery power gets low, ROBOT automatically switches to Return to Charger Mode and returns to the Charging Dock to	This is normal. No solution necessary.
		Working time varies according to floor surface, room complexity and the selected Cleaning Mode.	This is normal. No solution necessary.
4	ROBOT will not clean automatically at scheduled time.	ROBOT is powered OFF.	Power ON ROBOT.
		the robot's battery is low.	Keep ROBOT powered ON and on the Charging Dock to make sure it has full battery to work at any time.
		the robot's Suction Intake is blocked and/or its components are tangled with debris.	Power OFF ROBOT, clean the Dust Bin and invert the robot. Clean the Suction Intake and Side Brushes as described in section 4 Maintenance.
5	Remote Control failure (effective control range of Remote Control is 5m/16').	The battery in the Remote Control need to be replaced.	Replace with a new battery making sure it is installed correctly.
		ROBOT is powered OFF or the robot's battery is low.	Make sure ROBOT is powered ON and fully charged.
		The infrared signal cannot be transmitted because the Infrared Emitter on Remote Control or the Infrared Receiver on ROBOT is dirty.	Use clean dry cloth or the brush side of the provided Multi- Function Cleaning Tool to wipe the Infrared Emitter on Remote Control and the Infrared Receiver on ROBOT.
		There is other equipment interfering with the infrared signal to ROBOT	Avoid using the Remote Control near other equipment using infrared signals



TIPS:

Your suggestions and comments for Costway are really important to us!
We sincerely solicit you to go back to our shop and leave a good rating in just a simple click. It would be quite encouraging if you could kindly do so like below:

★★★★★ Great products so far

February 24, 2018

Great product so far. Fast delivery, easy setup, and working without any issues.

With your inspiring rating, Costway will be more consistent to offer you
EASY SHOPPING EXPERIENCE, GOOD PRODUCTS and EFFICIENT SERVICE!



WHERE THERE IS COSTWAY THERE IS HOME

